

**PROPOSED PREFABRICATED SYNTHETIC JOGGING TRACK
SURFACING AT NAIROBI CLUB, NAIROBI COUNTY**

FOR

NAIROBI CLUB

BILLS OF QUANTITIES

MARCH 2025

BILLS OF QUANTITIES FOR

PROPOSED SYNTHETIC JOGGING TRACK SURFACING AT NAIROBI CLUB, NAIROBI COUNTY

FOR NAIROBI CLUB

ISSUED BY:-

**MOBB Intricate Limited
P.O. Box 2771-00606
NAIROBI**

The Contract for the above-mentioned Works, entered into on the

_____ day of _____ 2025

by the undersigned parties refers to these Bills of Quantities

which shall be read and construed as part of the said Contract.

(EMPLOYER/CLIENT)

(CONTRACTOR)

DATE _____ **2025**

DATE _____ **2025**

INSTRUCTIONS TO TENDERERS

- 1 The Tender Documents provided for this proposed Project consists of the following:
 - * Instructions to Tenderers
 - * Form of Tender
 - * Form of Surety Undertaking
 - * Bills of Quantities as contained herein
 - * Architectural Drawings

- 2 Tenderers are advised that the individual rates entered in this schedule of rates are to be **INCLUSIVE of VAT**

- 3 The Contractor is required to check the numbers of the pages and should any be found to be missing or in duplicate or the figures or writing indistinct, they must inform the Quantity Surveyors at once and have the same rectified. Should the Contractor be in doubt about the precise meaning of any item, word or figure, for any reason whatsoever, or observe any apparent omission of words or figures they must inform the Quantity Surveyor in order that the correct meaning may be decided upon before the date for the submission of the Tender.

- 4 No liability whatever will be admitted nor claim allowed in respect of errors in the Contractor's Tender due to mistakes in the Bills of Quantities which should have been rectified in the manner described above.

- 5 Any doubt or obscurity as to the meaning or intention of any part of the tender documents, or any question arising, shall be taken up in writing, before submission of the tender so that the same can be clarified.

- 6 The Contractor shall not alter or otherwise qualify the text of these Bills of Quantities. Any alteration or qualification made without authority will be ignored and the text of the Bills of Quantities as printed will be adhered to.

- 7 The Contractor shall be deemed to have made allowance in their prices generally to cover items of Preliminaries or additions to Prime Cost Sums or other items, if these have not been priced against the respective items.

- 8 All items of measured work shall be priced in detail and tenders containing lump sums to cover trades or groups of work must be broken down to show prices for each item before they will be accepted. Lump sums to cover items of Preliminaries shall likewise be broken down if so required.

- 10 In no case will any expenses incurred by Contractors in preparation of this Tender be reimbursed.

- 11 The copyright of these Bills of Quantities is vested in the Quantity Surveyors and no part thereof may be reproduced without their express permission given in writing.

- 12 The Contractor is solely responsible for the accurate ordering of materials in accordance with the Drawings and Architect's instructions and no claims for any loss or expense will be entertained for orders for materials based upon the Bills of Quantities.

- 13 The Tender Documents must be filled in Kenya currency, i.e. Shillings and Cents.

- 14 No Working space has been allowed in works of excavations.Tenderer to note this when pricing

- 15 The tender shall be validly witnessed

16 The total of the tender price as submitted will be corrected, if errors in computation of the tender or other mistakes are found during examination of the tender. The error will be communicated to the tenderer and the mode of correction, first, discussed with the Tenderer. Errors will include the following:

Errors will include the following:

- * Arithmetical errors which includes but not limited to errors in extensions, additions, transfers and discounts .
- * Discrepancy between words and figures

Arithmetical errors shall be corrected, either by:-

- * way of a percentage omission of addition to the builder's work content of the tender, excluding prime cost and provisional sums but including preliminaries so that the total tender after adjustment remains the same as the original tender offer, or
- * where there is a discrepancy between the unit rate and the line item total resulting from multiplying the unit rate by the quantity, the unit rate as quoted will prevail. Unless in the opinion of the employer, there is an obvious typographical error in which case the adjustment will be made to the entry containing that error .
- * The amount stated in the tender will be adjusted in accordance with the above procedure for the correction of errors and, with concurrence of the tenderer, shall be considered as binding upon the tenderer. If the tenderer does not accept the corrected amount, the tender may be rejected and the tender security may be forfeited.

If there is a discrepancy between words and figures, the amount in words shall prevail.

17 Site Visit

The tenderer, at the tenderers own responsibility and risk, is encouraged to visit and examine the site of the works and its surrounding, and obtain all information that may be necessary for preparing the tender and entering into a contract for construction of the works. The costs of visiting the site shall be at the tenderers own expense.

The tenderer and any of his personnel or agents will be granted permission by the employer to enter upon premises and lands for the purpose of such inspection or visit, but only upon the express condition that the tenderer, his personeel or agents, will release and indemnify the employer from and against all liability in respect of, and will be responsible for personal injury (whether fatal or otherwise), loss of or damage to property and any other loss, damage, costs and expenses however caused, which but for the exercise of such permission, would not have arisen.

FORM OF TENDER

PROPOSED SYNTHETIC JOGGING TRACK SURFACING AT NAIROBI CLUB, NAIROBI COUNTY

FOR NAIROBI CLUB

**NAIROBI CLUB
P.O BOX**

Sir(s)

*I / We
, having read the specifications, conditions of contract and bills of quantities delivered to *me /us and having examined the drawings referred to, hereby offer to execute and complete in accordance with Agreement and Schedule of Conditions of Contract (with quantities) for the sum and within the time stated below

KENYA SHILLINGS

.....(WORDS)

KSHS.(FIGURES)

TIME FOR COMPLETION WEEKS FROM THE DATE OF
COMMENCEMENT OF THE
WORKS

*I/We, the undersigned, agree that if our tender is accepted we will enter into a Bond for the due performance of the Contract with the Guarantor described in the Form of Surety Undertaking (annexed hereto), who shall be either a Bank, Insurance Company or Finance House to whom you shall not unreasonably object within fourteen days accepted of our tender.

*I/We, the undersigned, agree that unless and until a form agreement is executed, this Tender, together with your acceptance thereof, shall constitute a binding contract between *me/us and yourself, and this Tender shall remain valid for **ninety (90) days** from delivery of Tenders.

* I/ We, the undersigned, have examined all the documents detailed previously which shall form part of this contract and have no objections relating to them.

* I/We, the undersigned, understand that the lowest, or any portion of Tender, will not necessarily be accepted nor will any expences incurred by *me/us in the preparation of this Tender be reimbursed.

* Delete whichever is not applicable

FORM OF TENDER

PROPOSED SYNTHETIC JOGGING TRACK SURFACING AT NAIROBI CLUB, NAIROBI COUNTY

FOR NAIROBI CLUB

TENDERER

NAME

SIGNATURE

ADDRESS

OFFICIAL
STAMP

TELEPHONE
CONTACT

DATE

WITNESS

NAME

SIGNATURE

ADDRESS

OFFICIAL
STAMP

TELEPHONE
CONTACT

DATE

PERFORMANCE BOND UNDERTAKING

**NAIROBI CLUB
P.O BOX**

Sir(s)

We (Surety)

of (Address)

are willing to act as Surety and to be bound to you for the Erection and Completion of Synthetic Jogging Track System for **Nairobi Club** in the amount equivalent to 10% of the contract sum and according to the terms and conditions of the Contract, together with the variations made thereto in the Preliminaries Section of the Bills of Quantities, a copy of which has been inspected by us,without addition of any limitations.

We undertake to pay you,upon your first written demand and without cavil or argument,any sum or sums as aforesaid without your needing to prove or to show grounds or reasons for your demand for the sums specified herein. him,owing to the occurrence of the one or both of the two conditions,specifying the occurred condition or conditions.

We hereby waive the necessity of your demanding the said debt from the contractor before presenting us with the demand. We further agree that no change,addition or other modification of the terms of the contract or of the works to be performed there under or of any of the contract documents which may be made between you and the contractor shall in any way release us from any liability under this guarantee and we hereby waive notice of any change,addition or modification.

This guarantee shall be valid until the date of issue of the certificate of completion

We also agree to enter into a Bond under the above terms within seven days of being called upon to do so.

**Signature and Official
Stamp of Surety**

.....

Date

.....

Witnessed by

Name of Witness

.....

Signature of Witness

.....

Address of Witness

.....

Telephone Contact

.....

Date

.....

SECTION NO. 02: CONDITIONS AND SPECIFICATIONS

PART 1 – GENERAL

1.1 SUMMARY

- A. This section covers all labor and materials required to install a first-class track & field surface. The Track & Field Synthetic Surfacing Contractor is responsible for installing all track & field synthetic surfacing materials and line markings as designated in these specifications.

1.2 CODES AND STANDARDS

- A. Codes and standards follow the current guidelines set forth by the National Building Code

1.3 SUBMITTALS

- A. The following information must be submitted by the Track & Field Synthetic Surfacing Contractor prior to installation.
 - 1. Test results, from an IAAF certified laboratory, verifying manufacturer's Track & Field Synthetic Surfacing product meets the IAAF Performance Specifications for Synthetic Surfaces.
 - a. The same components from the test sample must be used in the installed surface. No substitutions will be allowed.
 - b. TRRL Pendulum test results for slip resistance must be greater than 47.
 - 2. Surfacing Contractor On-site Project Manager/Superintendent Qualifications:
 - a. The project manager/superintendent for the surfacing contractor will be on-site during all surfacing operations. Substitution of project manager/superintendent shall not be permitted.
 - b. A list of completed facilities, minimum of 5, which are certified to meet the current rules & regulations in the past 5 years utilizing the product specified in these specifications. The Track & Field Synthetic Surfacing Contractor's project manager/supervisor responsible for the completed facilities must supervise this project.
 - 3. Standard printed specifications of the track & field synthetic surfacing system that is being installed.

4. Installation process and requirements for subbase (stone, asphalt, and concrete) and any conditions that may limit the track & field synthetic surface installation or affect quality of installation.
 5. Temperature/climatic conditions limiting quality of installation.
 6. Standard specification and application for recommended subbase primers, crack filler, patching and leveling material.
 7. Two product samples, a minimum of 6" x 6" in size, the same color, texture, thickness, etc. of the same type of surfacing to be installed for this project. This must be a representative sample of the product. This sample must be submitted and approved by the Owner prior to installation. At completion of the project this sample may be used as a comparison to judge the quality of the installed product.
 8. Material safety data sheets on all individual components of the product being installed.
 9. Provide a letter stating the Track & Field Synthetic Surfacing Contractor reviewed the asphalt specification and are accepting the specification as correct. Upon completion of the Asphalt paving and prior to installation of the track & field synthetic surface, the Track & Field Synthetic Surfacing Contractor will provide a letter accepting the installed asphalt and stating it is suitable to receive the track & field synthetic surface.
 10. Letter from synthetic surfacing manufacturer approving the installer/applicator of the synthetic surface listed in these specifications.
 11. Written notice and acceptance that all in-ground field event equipment is installed as per the
Contract Documents and the rules of the sport.
- B. The following information shall be submitted after completion of the specified work:
1. Provide a copy of the Track & Field Synthetic Surface vendor's standard Warranty noting any exceptions to the Warranty information included in this Specification Section.
 2. Provide a Care and Maintenance manual for the Owner's use in maintaining the synthetic surfacing.

1.4 QUALITY ASSURANCE

- A. Prior to installation, or during installation or at completion of installation of the synthetic surfacing, if the Owner has any question or doubt about the quality or formulation of the material, the Track & Field Synthetic Surfacing Contractor shall have the product tested. If the product meets these specifications, then the Owner shall pay for the cost of the testing; if the product does not meet these specifications, then the Track & Field Synthetic Surfacing Contractor shall pay for the testing. Any material failing to meet specifications will be replaced with new material at the Track & Field Synthetic Surfacing Contractor's expense.
- B. Slopes and Tolerances:
 - 1. The maximum lateral inclination permitted for the track across the full width of the track, and across all runways, shall not exceed 2:100, 2.0 percent.
 - 2. The maximum overall downward inclination permitted in the running direction for the track,
the running direction for all runways and the throwing direction for all landing sectors shall not exceed 1:1,000, 0.1 percent. Inclination shall be measured by comparing the start and end
points of the races that use the straightaway portion of the oval, the last 20 meters of the javelin runway, the start and end points of other runways, not to exceed 40 meters, and the full graded length of each landing sector.

1.5 SPECIAL PROJECT CONDITIONS

- A. The Track & Field Synthetic Surfacing Contractor will provide a project manager/superintendent on-site daily through the completion of the Track & Field Synthetic Surfacing Contractor's portion of the contract.
 - 1. The on-site project manager/superintendent shall remain on site through the completion of the project. Substitution of project manager/superintendent shall not be permitted.
- B. The Track & Field Synthetic Surfacing Contractor will provide a technician that will serve as a consultant to the Owner and Contractor during the Asphalt Paving, first reviewing the asphalt specification, accepting the specification as correct, and then, providing daily review and guidance of the construction of the Asphalt Paving

which will directly affect the tolerances and longevity of the eventual synthetic surfacing installation.

- C. Prior to installing any concrete the Contractor must verify with the Track & Field Synthetic Surface manufacturer if any curing compounds or agents are allowed or acceptable.

1.6 SPECIFIC SCOPE OF WORK

- A. The Track & Field Synthetic Surfacing Contractor shall verify the entire track & field subbase and all events to determine that:
 - 1. The synthetic surface for the 432 meter track oval will accurately fit onto the Asphalt Paving base.
 - 2. That slopes and elevations meet required tolerances.
 - 3. No bird baths exceed the allowable limits as specified.
 - 4. The track & field areas will meet or exceed the rules of the sport.
- B. The Track & Field Synthetic Surfacing Contractor shall provide all labor, materials and equipment to perform the following work:
 - 1. The Track & Field Synthetic Surfacing Contractor is responsible for installing all track & field synthetic surfacing materials and line markings as designated in these specifications.
 - 2. Review Bidding documents and specifications, provide technical assistance, and approve Asphalt Paving base work as required in the specifications.
 - 3. Review and approve installation of all field event in-ground equipment before any track & field synthetic surfacing is installed as specified and shown on the Drawings.
 - 4. Brush and wash down all areas to be surfaced, as often as necessary during the installation of the track and field synthetic surface.
 - 5. Repair all birdbaths as required in these specifications.
 - 6. Install removable track & field synthetic surfacing (full pour polyurethane) plugs in all pole vault boxes and long/triple jump take-off boards (1-inch by 1-inch corner notches in one short side).
 - 7. Install special material (i.e., foam, board, etc.) in slot drain opening to prevent polyurethane from entering the opening. The drainage slot opening shall be

neatly trimmed out (vertical cuts), after polyurethane installation, to allow proper drainage to occur. No polyurethane is allowed on the inside of the drainage slot opening. This shall apply only if the precast slot drain is installed.

8. Repair all damaged areas, clean-up all glue, and remove excess polyurethane, primers and similar products. All trim cuts shall be neat and clean; on all curves the trim-out shall follow a radius line for accuracy and neatness.

1.7 WARRANTY/GUARANTEE

- A. General: Warranties / Guarantees specified in this Article shall not deprive the Owner of other rights the Owner may have under other provisions of the Contract Documents and are in addition to and run concurrent with other warranties/guarantees made by the Contractor under requirements of the Contract Documents.
- B. The following are inclusive of the term "Track & Field Synthetic Surface" for provisions of the guarantee:
 1. All slopes & tolerances as required in this specification.
 2. Synthetic track & field surface product as specified and represented by the Track & Field Synthetic Surface Manufacturer.
 3. All materials and products specified.
 4. All line markings installed in accordance with the Contract Documents.
- C. Track & Field Synthetic Surface Installer Guarantee: Provide in writing a "Full System Guarantee" agreement. The Principal (s) of both the Track & Field Synthetic Surface Installer and the Track & Field Synthetic Surface Manufacturer (if different) shall sign this document and it shall include the following:
 1. All work executed under this section will be free from defects of material and workmanship for the specified period from date of Substantial Completion/Acceptance of the Owner.
 2. Any defects will be remedied on written notice at no additional cost to the Owner.
 3. The warranty shall not be prorated.
 4. All material shall be guaranteed to the extent that the surfacing:
 - a. Has been manufactured, applied and will perform in accordance with these and the manufacturer's specifications.

- b. Will hold fast and/or adhere to the primer, asphalt, concrete, edging, filler, patches, or overlay materials.
 - c. Is Ultra-Violet resistant, will not bubble, blister, fade, crack, or wear excessively during the warranty period.
- D. The Track & Field Synthetic Surfacing Contractor shall, in the presence of the Owner, inspect the track and field synthetic surfacing each year until the end of the warranty period, or at any time requested by the Owner. Any defects in workmanship or materials (at no fault of the Owner) shall be repaired at the expense of the Track & Field Synthetic Surfacing Contractor to the satisfaction of the Owner.
- E. Contractor shall not be held liable for incidental or consequential damages. The Track & Field Synthetic Surface Warranties described shall be conditioned upon:
 - 1. Owner shall maintain track as described in the Owner's Manual submitted by the Contractor to the Owner.
- F. The Warranty does not cover any defect, failure, damage caused by or connected with abuse, neglect, deliberate acts, acts of God, casualty or loads exceeding the Contractor's recommendations.
- G. Warranty period to be five (5) years minimum.

PART 2 – PRODUCTS

2.1 TRACK & FIELD SYNTHETIC SURFACE

- A. The track and field synthetic surface shall be as per the manufacturer's specifications.
- B. Patching Material: All materials must be approved materials and compatible with the synthetic surface.

PART 3 – EXECUTION

3.1 INSPECTION AND ACCEPTANCE

- A. Examine all surfaces and contiguous elements to receive work of this section and correct, as part of the Work of this Contract, any defects affecting installation.
- B. Commencement of work will be construed as complete acceptability of surfaces and contiguous elements.

3.2 INSTALLATION REQUIREMENTS

- A. The following installation requirements must be met by the Track & Field Synthetic Surfacing

Contractor:

1. Installation by synthetic surface manufacturer approved project manager/superintendent applicators and technicians. Local laborers may be hired for non-technical work, only.
2. Priming - The primer shall be spray-applied in accordance with the manufacturer's specifications. Only those areas which can be installed the same day should be primed. All concrete areas to be surfaced shall receive manufacturer's approved primer.

3.3 INSTALLATION OF SYNTHETIC TRACK SURFACING

- A. Thickness to match sample submitted to IAAF certified testing laboratory.

3.5 TIMING, LIMITATIONS, AND CONDITIONS AFFECTING INSTALLATION

- A. The track surfacing material shall be applied no sooner than 28 days after placement of the asphalt top course.
- B. Weather and Climate: If in the opinion of the synthetic track surfacing manufacturer or the Owner, weather and climatic conditions are having or will have an adverse effect on installation; work shall be delayed until the adverse condition has passed.
- C. Adjacent and Concurrent Construction: Installation shall not take place until the completion of the adjacent or concurrent construction operations which generate dust, airborne abrasives, or any other by-product that, in the opinion of the Owner or synthetic track surfacing manufacturer, would be harmful to the track material. Under specific direction of the Owner, the Track & Field Synthetic Surfacing Contractor may be allowed to cover the track material with an approved covering if such harmful construction operations must occur after the track material has been installed.

**SECTION NO. 03: SYNTHETIC RUNNING
TRACK SURFACING**

Item	Description	Unit	Qty	Rate	Amount [Kshs]
	<p><u>SECTION NO. 03: SYNTHETIC RUNNING TRACK SURFACING</u></p> <p><u>PRICING NOTES</u></p> <p>1) The Bills of Quantities must be priced in Kenya Shillings</p> <p>2) Price quoted shall include costs of line markings as per the drawings</p> <p>3) Price quoted shall include supervision costs by a qualified synthetic running track surfacing superintendent/project manager</p> <p>4) Price quoted shall include all preliminary costs required to carry out and complete the works.</p> <p>5) Price quoted shall include all taxes and levies as per the Laws of Kenya</p> <p><u>SYNTHETIC RUNNING TRACK SURFACING</u></p> <p>A Supply and install as per manufacturer's instructions; 12mm thick prefabricated synthetic running track system including centre line marking</p>	SM	1,980		
TOTAL AMOUNT VAT INCLUSIVE CARRIED TO FORM OF TENDER					

Amount in Words: _____

Tenderer's Official Stamp

Signed: _____ Date: _____

Witness: _____

Singed: _____

Address: _____

Date: _____

ARCHITECTURAL DRAWINGS



ARCHITECTS

MIO
BIB
INTRICATE

PROJECT
NAIROBI CLUB JOGGING TRACK

CLIENT
NAIROBI CLUB

LOCATION
NAIROBI

Date Published:25/02/2025

PROPOSED JOGGING TRACK NAIROBI CLUB

Project Number: Project Number

Drawings and Specifications as instruments of service are and shall remain the property of the Architect. They are not to be used on extensions of the project, or other projects, except by agreement in writing and appropriate compensation to the Architect.

The General Contractor is responsible for confirming and correlating dimensions at the job site. The Architect will not be responsible for construction means, methods, techniques, sequences, or procedures, or for safety precautions and programs in connection with the project.

© 2025 - Architect Co

Ensure that all surface water is removed from the site at a rate which will safeguard against surface flooding occurring.

Ensure that the rate of track runoff after heavy rain during competition meets the requirements of UKA and World Athletics that all water has gone within 30 minutes.

Ensure that the general rate of runoff meets Local Water Authority regulations that prevent overloading local networks; this may require installation of attenuation tanks within the track footprint.

Ensure the attenuation system can be used for water harvesting to save water and reduce water costs for irrigation.

Consider the use of Sustainable Urban Drainage Systems – SUDS if planning approvals state that control of surface water into local sewers.

Not allow excess water to remain present in the construction which might result in a reduction of the load bearing capacity of the formation or in any frost damage to the construction.

Protect the installation from the effects of ground or surface water from the surrounding areas.

NOT FOR REGULATORY APPROVAL, PERMITTING, OR CONSTRUCTION

ISSUED:

Tuesday, 25 February 2025

Main Level Plan

A102

Printed: 25/02/2025

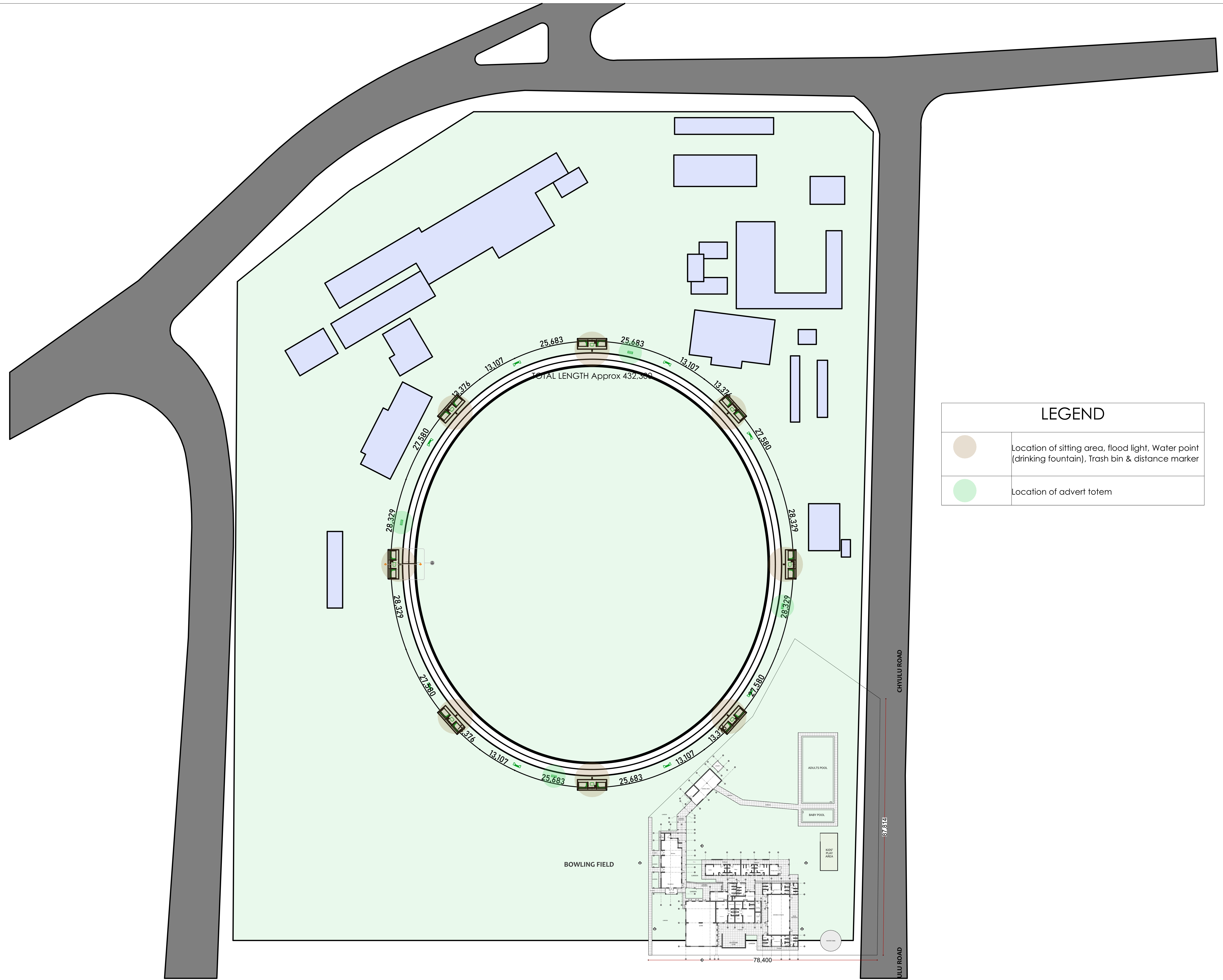

SITE PLAN

1:600

PROPOSED JOGGING TRACK NAIROBI CLUB

Project Number: Project Number

Drawings and Specifications as instruments of service are and shall remain the property of the Architect. They are not to be used on extensions of the project, or other projects, except by agreement in writing and appropriate compensation to the Architect.

The General Contractor is responsible for confirming and correlating dimensions at the job site. The Architect will not be responsible for construction means, methods, techniques, sequences, or procedures, or for safety precautions and programs in connection with the project.

© 2025 - Architect Co

Ensure that all surface water is removed from the site at a rate which will safeguard against surface flooding occurring.

Ensure that the rate of track runoff after heavy rain during competition meets the requirements of UKA and World Athletics that all water has gone within 30 minutes.

Ensure that the general rate of runoff meets Local Water Authority regulations that prevent overloading local networks; this may require installation of attenuation tanks within the track footprint.

Ensure the attenuation system can be used for water harvesting to save water and reduce water costs for irrigation.

Consider the use of Sustainable Urban Drainage Systems – SUDS if planning approvals state that control of surface water into local sewers.

Not allow excess water to remain present in the construction which might result in a reduction of the load bearing capacity of the formation or in any frost damage to the construction.

Protect the installation from the effects of ground or surface water from the surrounding areas.

NOT FOR REGULATORY APPROVAL, PERMITTING, OR CONSTRUCTION

ISSUED:

Tuesday, 25 February 2025

PLAN Detail

A103

Printed: 25/02/2025

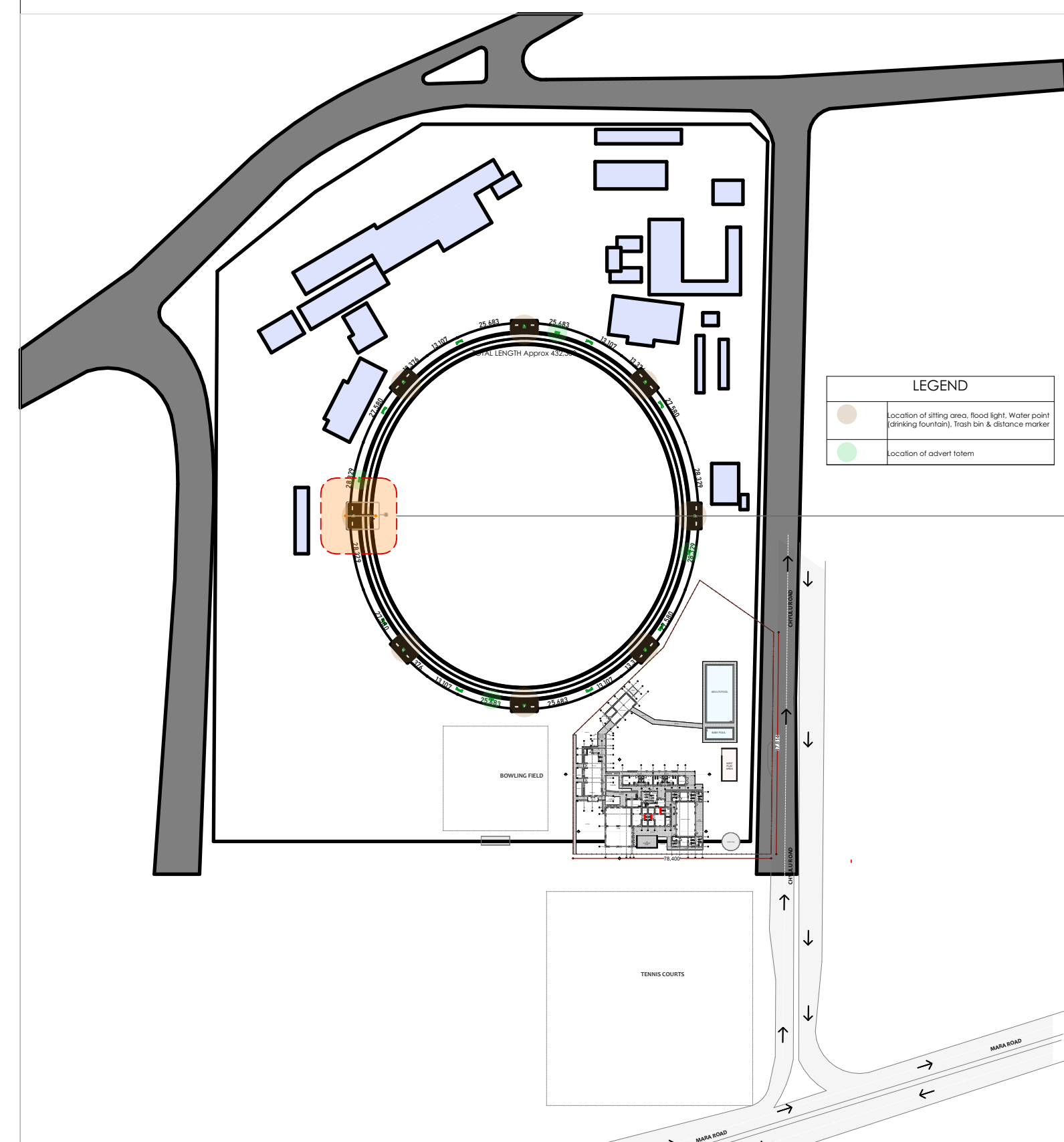

1 SITE PLAN 1:2000

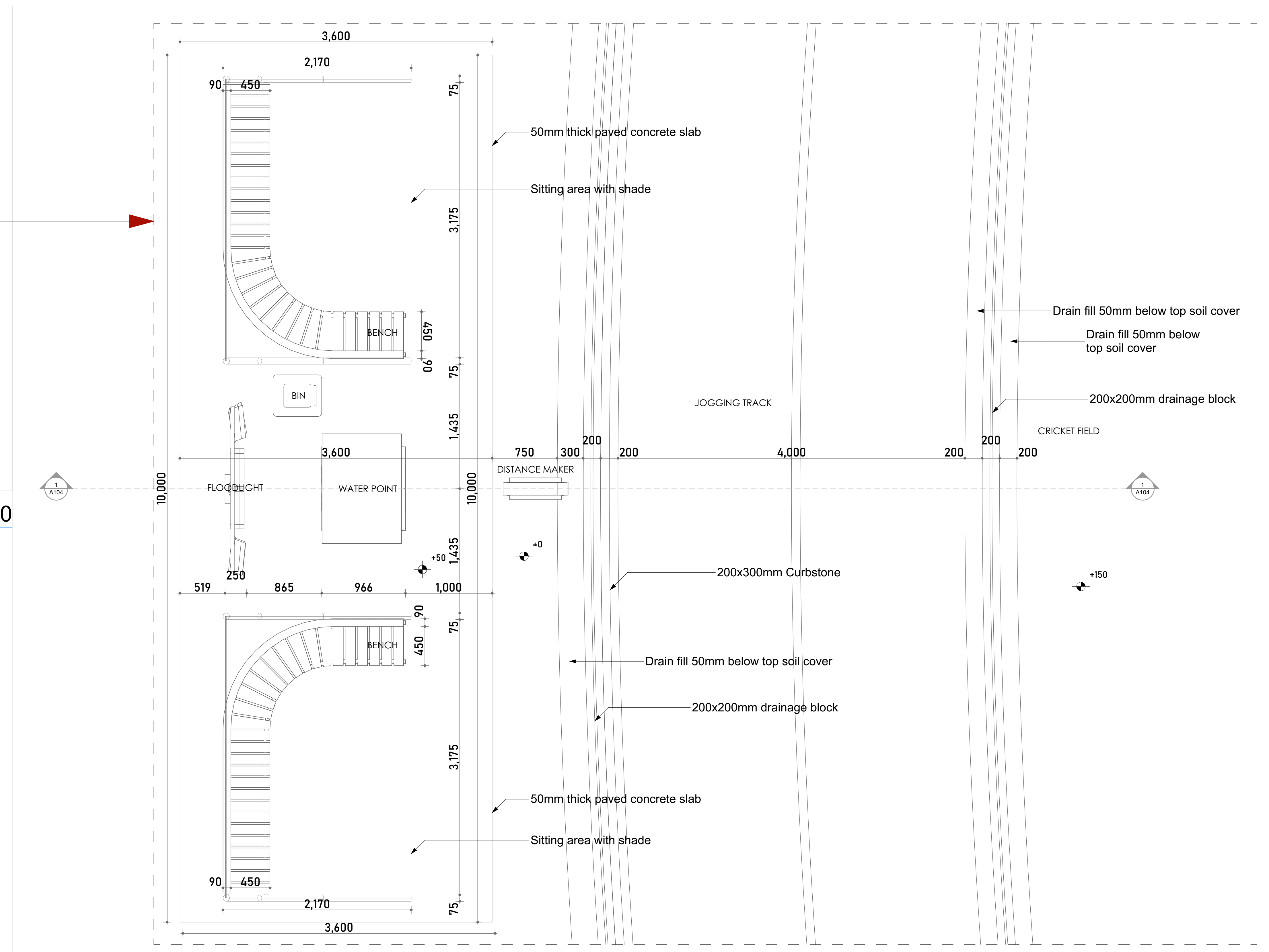

3 D-01 DETAIL 1:25

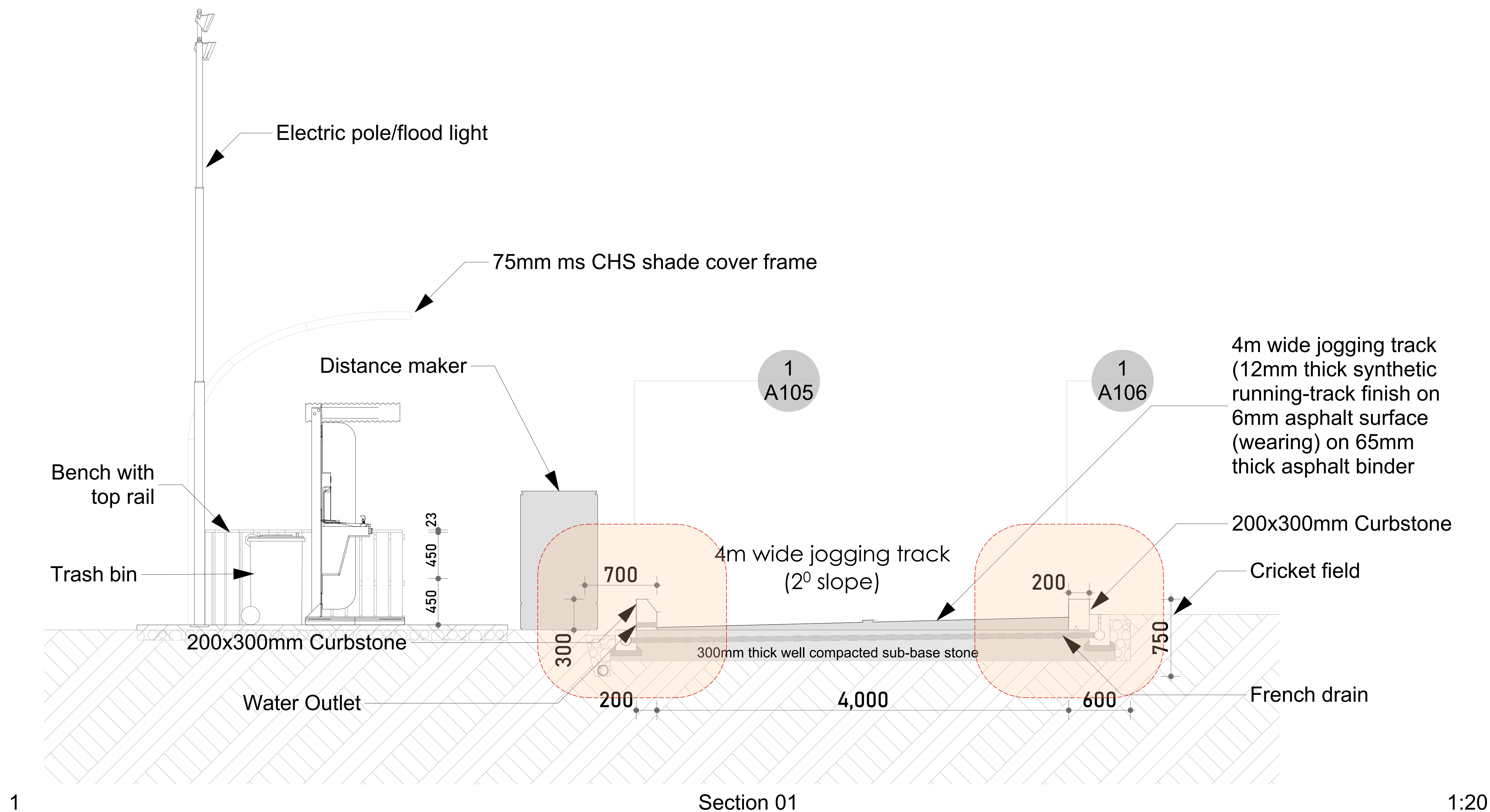

1

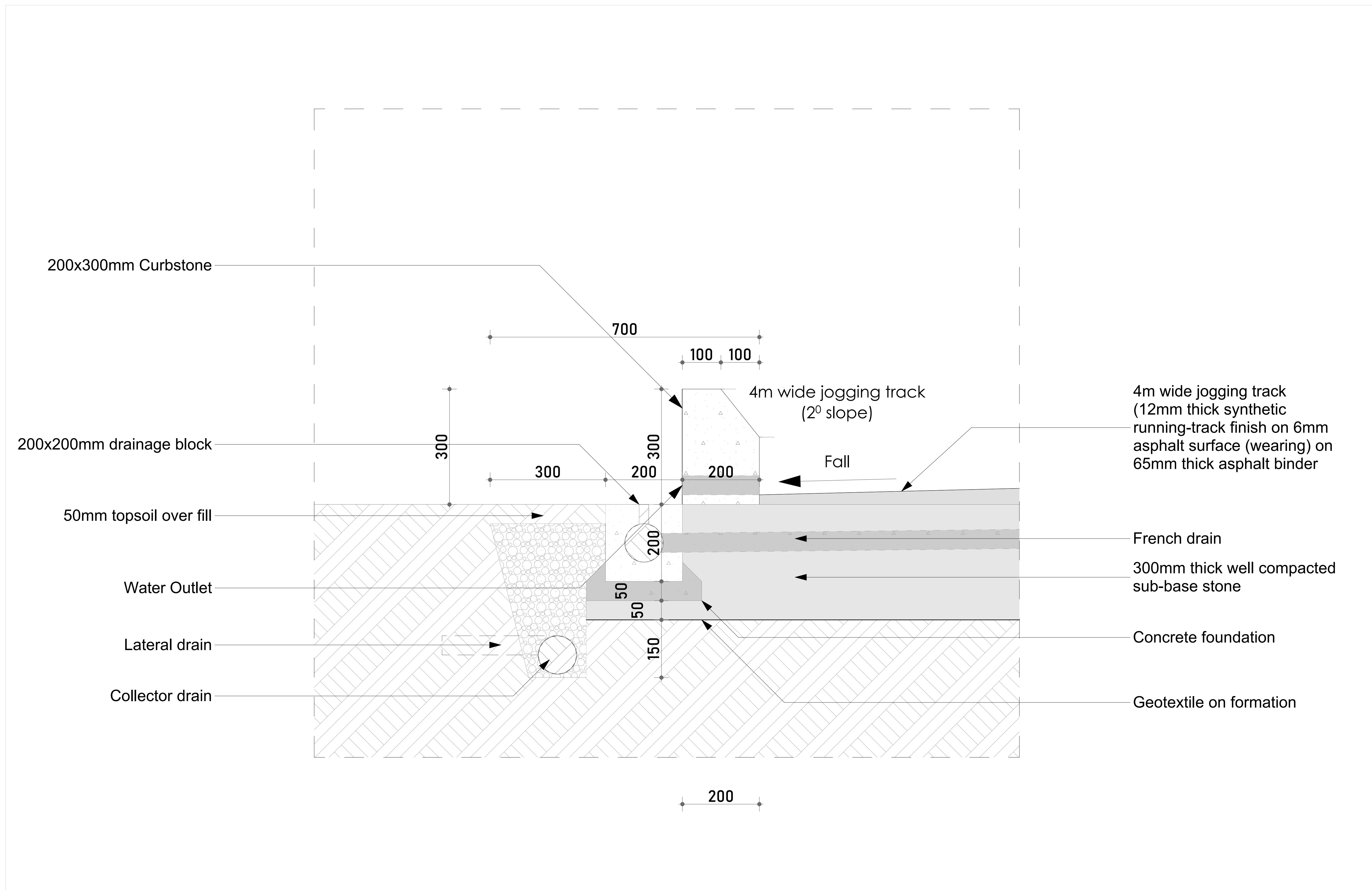

200x300mm Curbstone

200x200mm drainage block

50mm topsoil over fill

Water Outlet

Lateral drain

Collector drain

700

100 100

300

300

200

200

200

50

50

150

200

4m wide jogging track
(2° slope)

Fall

4m wide jogging track
(12mm thick synthetic
running-track finish on 6mm
asphalt surface (wearing) on
65mm thick asphalt binder

French drain

300mm thick well compacted
sub-base stone

Concrete foundation

Geotextile on formation

NOT FOR REGULATORY APPROVAL, PERMITTING, OR CONSTRUCTION

ISSUED:

Tuesday, 25 February 2025

Detail 03

A106

Printed: 25/02/2025

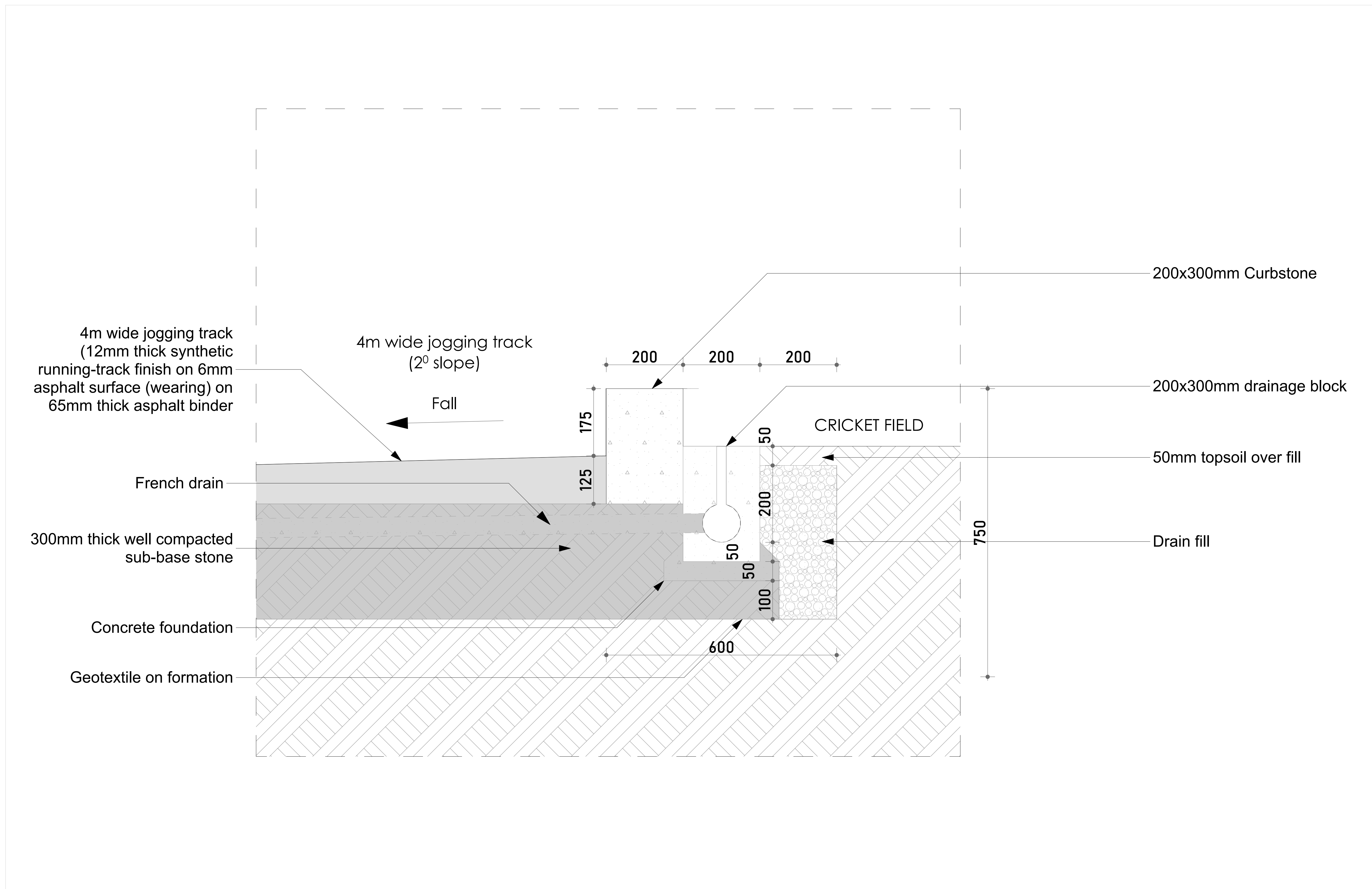

4m wide jogging track
(12mm thick synthetic
running-track finish on 6mm
asphalt surface (wearing) on
65mm thick asphalt binder

4m wide jogging track
(2° slope)

Fall

French drain

300mm thick well compacted
sub-base stone

Concrete foundation

Geotextile on formation

200x300mm Curbstone

200x300mm drainage block

50mm topsoil over fill

Drain fill

CRICKET FIELD

NOT FOR REGULATORY APPROVAL, PERMITTING, OR CONSTRUCTION

ISSUED:

Tuesday, 25 February 2025

3D

A107

Printed: 25/02/2025

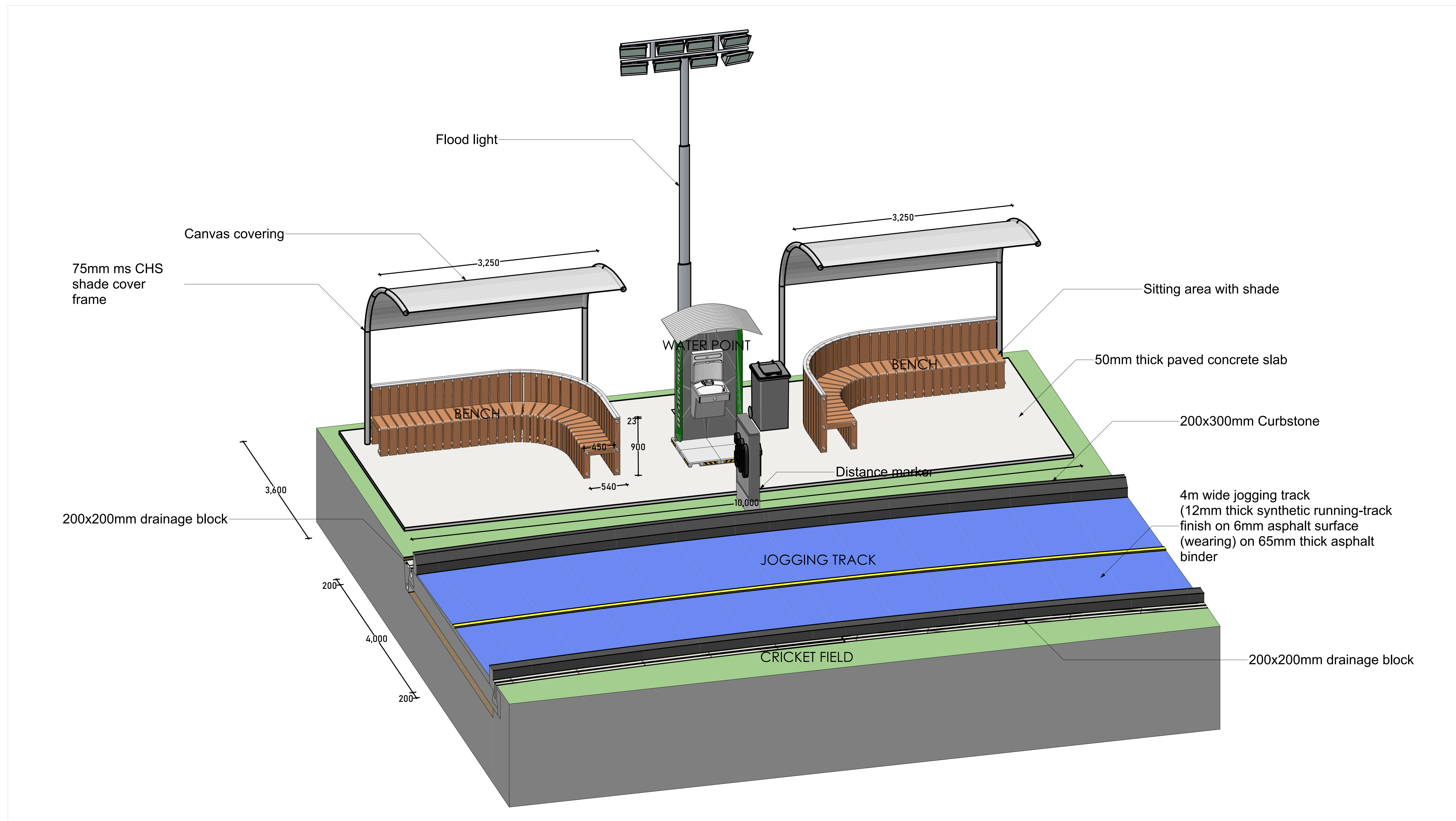

1 3D-01 Jogging track 3D 1:30



PROPOSED JOGGING TRACK NAIROBI CLUB

Project Number: Project Number

Drawings and Specifications as instruments of service are and shall remain the property of the Architect. They are not to be used on extensions of the project, or other projects, except by agreement in writing and appropriate compensation to the Architect.

The General Contractor is responsible for confirming and correlating dimensions at the job site. The Architect will not be responsible for construction means, methods, techniques, sequences, or procedures, or for safety precautions and programs in connection with the project.

© 2025 - Architect Co

Ensure that all surface water is removed from the site at a rate which will safeguard against surface flooding occurring.

Ensure that the rate of track runoff after heavy rain during competition meets the requirements of UKA and World Athletics that all water has gone within 30 minutes.

Ensure that the general rate of runoff meets Local Water Authority regulations that prevent overloading local networks; this may require installation of attenuation tanks within the track footprint.

Ensure the attenuation system can be used for water harvesting to save water and reduce water costs for irrigation.

Consider the use of Sustainable Urban Drainage Systems – SUDS if planning approvals state that control of surface water into local sewers.

Not allow excess water to remain present in the construction which might result in a reduction of the load bearing capacity of the formation or in any frost damage to the construction.

Protect the installation from the effects of ground or surface water from the surrounding areas.

NOT FOR REGULATORY APPROVAL, PERMITTING, OR CONSTRUCTION

ISSUED:

Tuesday, 25 February 2025

Image

A108



PROPOSED JOGGING TRACK NAIROBI CLUB

Project Number: Project Number

Drawings and Specifications as instruments of service are and shall remain the property of the Architect. They are not to be used on extensions of the project, or other projects, except by agreement in writing and appropriate compensation to the Architect.

The General Contractor is responsible for confirming and correlating dimensions at the job site. The Architect will not be responsible for construction means, methods, techniques, sequences, or procedures, or for safety precautions and programs in connection with the project.

© 2025 - Architect Co

Ensure that all surface water is removed from the site at a rate which will safeguard against surface flooding occurring.

Ensure that the rate of track runoff after heavy rain during competition meets the requirements of UKA and World Athletics that all water has gone within 30 minutes.

Ensure that the general rate of runoff meets Local Water Authority regulations that prevent overloading local networks; this may require installation of attenuation tanks within the track footprint.

Ensure the attenuation system can be used for water harvesting to save water and reduce water costs for irrigation.

Consider the use of Sustainable Urban Drainage Systems – SUDS if planning approvals state that control of surface water into local sewers.

Not allow excess water to remain present in the construction which might result in a reduction of the load bearing capacity of the formation or in any frost damage to the construction.

Protect the installation from the effects of ground or surface water from the surrounding areas.

NOT FOR REGULATORY APPROVAL, PERMITTING, OR CONSTRUCTION

ISSUED:

Tuesday, 25 February 2025

Image

A109



PROPOSED JOGGING TRACK NAIROBI CLUB

Project Number: Project Number

Drawings and Specifications as instruments of service are and shall remain the property of the Architect. They are not to be used on extensions of the project, or other projects, except by agreement in writing and appropriate compensation to the Architect.

The General Contractor is responsible for confirming and correlating dimensions at the job site. The Architect will not be responsible for construction means, methods, techniques, sequences, or procedures, or for safety precautions and programs in connection with the project.

© 2025 - Architect Co

Ensure that all surface water is removed from the site at a rate which will safeguard against surface flooding occurring.

Ensure that the rate of track runoff after heavy rain during competition meets the requirements of UKA and World Athletics that all water has gone within 30 minutes.

Ensure that the general rate of runoff meets Local Water Authority regulations that prevent overloading local networks; this may require installation of attenuation tanks within the track footprint.

Ensure the attenuation system can be used for water harvesting to save water and reduce water costs for irrigation.

Consider the use of Sustainable Urban Drainage Systems – SUDS if planning approvals state that control of surface water into local sewers.

Not allow excess water to remain present in the construction which might result in a reduction of the load bearing capacity of the formation or in any frost damage to the construction.

Protect the installation from the effects of ground or surface water from the surrounding areas.

NOT FOR REGULATORY APPROVAL, PERMITTING, OR CONSTRUCTION

ISSUED:

Tuesday, 25 February 2025

Image

A110



PROPOSED JOGGING TRACK NAIROBI CLUB

Project Number: Project Number

Drawings and Specifications as instruments of service are and shall remain the property of the Architect. They are not to be used on extensions of the project, or other projects, except by agreement in writing and appropriate compensation to the Architect.

The General Contractor is responsible for confirming and correlating dimensions at the job site. The Architect will not be responsible for construction means, methods, techniques, sequences, or procedures, or for safety precautions and programs in connection with the project.

© 2025 - Architect Co

Ensure that all surface water is removed from the site at a rate which will safeguard against surface flooding occurring.

Ensure that the rate of track runoff after heavy rain during competition meets the requirements of UKA and World Athletics that all water has gone within 30 minutes.

Ensure that the general rate of runoff meets Local Water Authority regulations that prevent overloading local networks; this may require installation of attenuation tanks within the track footprint.

Ensure the attenuation system can be used for water harvesting to save water and reduce water costs for irrigation.

Consider the use of Sustainable Urban Drainage Systems – SUDS if planning approvals state that control of surface water into local sewers.

Not allow excess water to remain present in the construction which might result in a reduction of the load bearing capacity of the formation or in any frost damage to the construction.

Protect the installation from the effects of ground or surface water from the surrounding areas.

NOT FOR REGULATORY APPROVAL, PERMITTING, OR CONSTRUCTION

ISSUED:

Tuesday, 25 February 2025

Image

A111



PROPOSED JOGGING TRACK NAIROBI CLUB

Project Number: Project Number

Drawings and Specifications as instruments of service are and shall remain the property of the Architect. They are not to be used on extensions of the project, or other projects, except by agreement in writing and appropriate compensation to the Architect.

The General Contractor is responsible for confirming and correlating dimensions at the job site. The Architect will not be responsible for construction means, methods, techniques, sequences, or procedures, or for safety precautions and programs in connection with the project.

© 2025 - Architect Co

Ensure that all surface water is removed from the site at a rate which will safeguard against surface flooding occurring.

Ensure that the rate of track runoff after heavy rain during competition meets the requirements of UKA and World Athletics that all water has gone within 30 minutes.

Ensure that the general rate of runoff meets Local Water Authority regulations that prevent overloading local networks; this may require installation of attenuation tanks within the track footprint.

Ensure the attenuation system can be used for water harvesting to save water and reduce water costs for irrigation.

Consider the use of Sustainable Urban Drainage Systems – SUDS if planning approvals state that control of surface water into local sewers.

Not allow excess water to remain present in the construction which might result in a reduction of the load bearing capacity of the formation or in any frost damage to the construction.

Protect the installation from the effects of ground or surface water from the surrounding areas.

NOT FOR REGULATORY APPROVAL, PERMITTING, OR CONSTRUCTION

ISSUED:

Tuesday, 25 February 2025

Image

A112



PROPOSED JOGGING TRACK NAIROBI CLUB

Project Number: Project Number

Drawings and Specifications as instruments of service are and shall remain the property of the Architect. They are not to be used on extensions of the project, or other projects, except by agreement in writing and appropriate compensation to the Architect.

The General Contractor is responsible for confirming and correlating dimensions at the job site. The Architect will not be responsible for construction means, methods, techniques, sequences, or procedures, or for safety precautions and programs in connection with the project.

© 2025 - Architect Co

Ensure that all surface water is removed from the site at a rate which will safeguard against surface flooding occurring.

Ensure that the rate of track runoff after heavy rain during competition meets the requirements of UKA and World Athletics that all water has gone within 30 minutes.

Ensure that the general rate of runoff meets Local Water Authority regulations that prevent overloading local networks; this may require installation of attenuation tanks within the track footprint.

Ensure the attenuation system can be used for water harvesting to save water and reduce water costs for irrigation.

Consider the use of Sustainable Urban Drainage Systems – SUDS if planning approvals state that control of surface water into local sewers.

Not allow excess water to remain present in the construction which might result in a reduction of the load bearing capacity of the formation or in any frost damage to the construction.

Protect the installation from the effects of ground or surface water from the surrounding areas.

NOT FOR REGULATORY APPROVAL, PERMITTING, OR CONSTRUCTION

ISSUED:

Tuesday, 25 February 2025

Image

A113

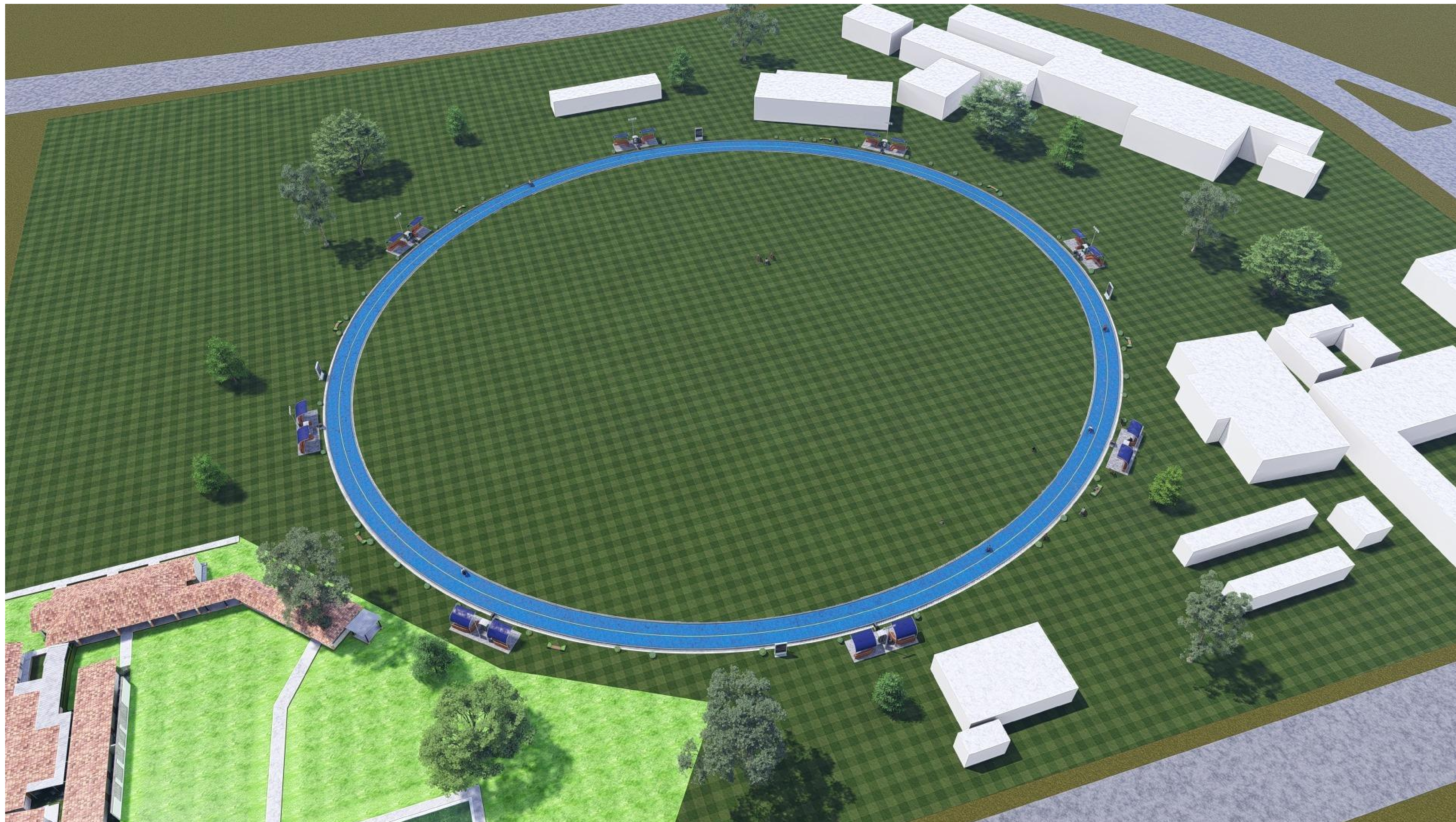

PROPOSED JOGGING TRACK NAIROBI CLUB

Project Number: Project Number

Drawings and Specifications as instruments of service are and shall remain the property of the Architect. They are not to be used on extensions of the project, or other projects, except by agreement in writing and appropriate compensation to the Architect.

The General Contractor is responsible for confirming and correlating dimensions at the job site. The Architect will not be responsible for construction means, methods, techniques, sequences, or procedures, or for safety precautions and programs in connection with the project.

© 2025 - Architect Co

Ensure that all surface water is removed from the site at a rate which will safeguard against surface flooding occurring.

Ensure that the rate of track runoff after heavy rain during competition meets the requirements of UKA and World Athletics that all water has gone within 30 minutes.

Ensure that the general rate of runoff meets Local Water Authority regulations that prevent overloading local networks; this may require installation of attenuation tanks within the track footprint.

Ensure the attenuation system can be used for water harvesting to save water and reduce water costs for irrigation.

Consider the use of Sustainable Urban Drainage Systems – SUDS if planning approvals state that control of surface water into local sewers.

Not allow excess water to remain present in the construction which might result in a reduction of the load bearing capacity of the formation or in any frost damage to the construction.

Protect the installation from the effects of ground or surface water from the surrounding areas.

NOT FOR REGULATORY APPROVAL, PERMITTING, OR CONSTRUCTION

ISSUED:

Tuesday, 25 February 2025

Image

A114



PROPOSED JOGGING TRACK NAIROBI CLUB

Project Number: Project Number

Drawings and Specifications as instruments of service are and shall remain the property of the Architect. They are not to be used on extensions of the project, or other projects, except by agreement in writing and appropriate compensation to the Architect.

The General Contractor is responsible for confirming and correlating dimensions at the job site. The Architect will not be responsible for construction means, methods, techniques, sequences, or procedures, or for safety precautions and programs in connection with the project.

© 2025 - Architect Co

Ensure that all surface water is removed from the site at a rate which will safeguard against surface flooding occurring.

Ensure that the rate of track runoff after heavy rain during competition meets the requirements of UKA and World Athletics that all water has gone within 30 minutes.

Ensure that the general rate of runoff meets Local Water Authority regulations that prevent overloading local networks; this may require installation of attenuation tanks within the track footprint.

Ensure the attenuation system can be used for water harvesting to save water and reduce water costs for irrigation.

Consider the use of Sustainable Urban Drainage Systems – SUDS if planning approvals state that control of surface water into local sewers.

Not allow excess water to remain present in the construction which might result in a reduction of the load bearing capacity of the formation or in any frost damage to the construction.

Protect the installation from the effects of ground or surface water from the surrounding areas.

NOT FOR REGULATORY APPROVAL, PERMITTING, OR CONSTRUCTION

ISSUED:

Tuesday, 25 February 2025

Image

A115